



Diode suppressor circuits for electrical and electronic control systems. Spark suppression diodes to prevent overvoltage in inductive loads such as solenoid valves, DC relays, DC valves etc.

Explosion protection

Marking ATEX	II 2G Ex db e IIC Gb II M2 Ex db e I Mb
Certification	PTB 97 ATEX 1068 U
Marking IECEx	Ex d e IIC Gb Ex d e I Mb
Certification	IECEx PTB 11.0083U
Marking CSA	Class I, Zone 1, IIC A/Ex d e [ia] IIC Gb
Certification	CSA 2011-2484303U
Other approvals and certificates, see www.bartec.de	

Technical data

Enclosure material	high-quality thermoplastic	
Protection class	Module	IP 66 EN/IEC 60529
	Terminals	IP 20 EN/IEC 60529
Terminals	2.5 mm ² , fine stranded	
Mounting rail	TH 35 x 7.5 (15) EN/IEC 60715	
Terminal designation	written marking labels	
Ambient temperature	-25 °C to +60 °C at T4	
Storage temperature	-40 °C to +70 °C	
Weight	0.250 kg	

1

Dimensions/mounting position

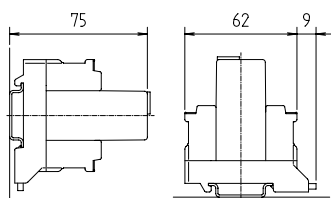

Module width: 30 mm

Electrical data

Rated voltage	400 V
Diode reverse voltage	1000 V
Diode current	max. 0.6 A, Type N4007 other types on request

Ordering information

Freewheeling diode, double **07-7311-63GF/5300**
 Technical data subject to change without notice.

Wiring diagram/terminal assignment

